

PORTABLE OUTLET

Model # PO160UPS

Uninterruptible Power Supply & CPAP Battery

INCLUDES:

- ① Rechargeable Lithium-ion 159W Battery
- ② 110V Charging Cord
- ③ Travel Bag



Owner's Manual

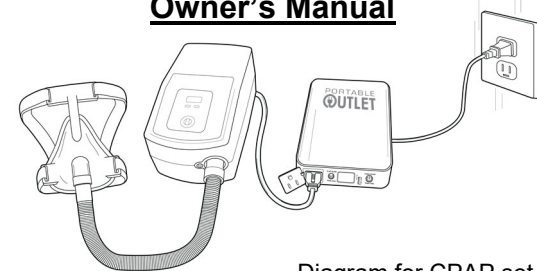

Diagram for CPAP set-up at home.
Also works as a stand-alone battery.

Portable Outlet a product of CPAP Life, LLC
1595 Peachtree Pkwy, #204-135, Cumming, GA 30041
Instructional videos at www.po160ups.com

470-297-5778
www.PortableOutlet.com

General Description

Thank you for purchasing the Portable Outlet, Uninterruptible Power Supply and CPAP Battery. Enjoy the peace of mind of knowing that if your home suffers a power outage, your CPAP therapy will continue to operate without interruption. It also works as a stand-alone battery to use while travelling or during existing power outages and emergencies.

WARNINGS

- Keep away from children. Do not let children play with or operate.
- Do not place objects in the outlet. Only use compatible, 110V cords from small devices (no plug cords with open or exposed wires).
- Not intended for bulky electronics that draw substantial power. (No appliances, coffee makers, microwave, power tools, etc.)
Attempts to power devices >100W will overload & may damage the battery. Your device voltage range must be 110V-125V/50-60Hz.
- Operate and charge between 40°F and 105°F.
- Keep away from liquids, flammable/explosive materials and fire.
- Do not expose to water or use in rain, snow or misty weather.
- Do not attempt to disassemble or open the product.
- Only use the charging cord included to power the battery.

Charging the Battery

- 1) Plug the charging cord into the AC Input port.

The AC Input is located on the right side, towards the back end of the battery.

The DC Input can be used with an approved DC car or solar charging system, sold separately.

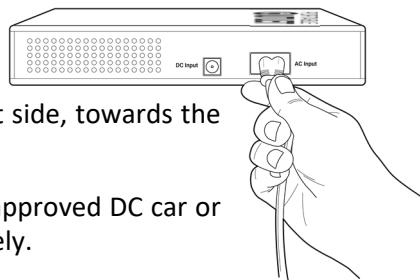

2

Setting up the Portable Outlet

- 2) Plug the other end of the charging cord into a wall outlet.

Leave this cord plugged in at all times, if you are using as an Uninterruptible Power Supply (UPS).

If you are using as a stand-alone battery, it should fully recharge in approximately 4 to 5 hours.

From left to right: AC Dust Cover, AC On/Off Button, Display Screen, USB Port and Main On/Off Button.

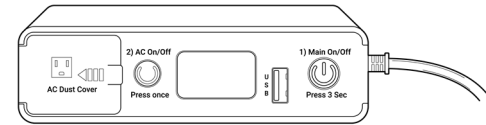

The display will stay blank until the Main On/Off button is pressed.

Plug your device into the AC Outlet

- 3) Open the Dust Cover and plug your device into the AC Outlet.

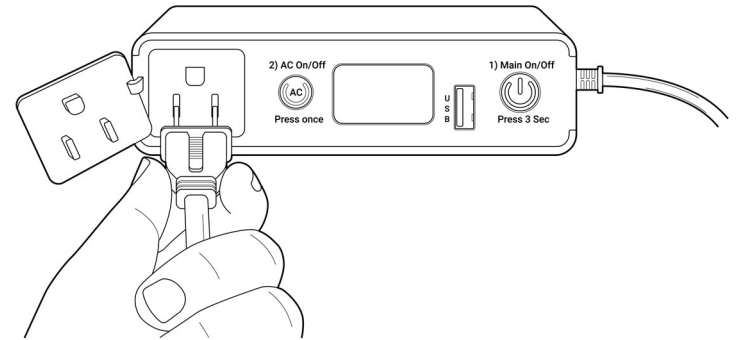

3

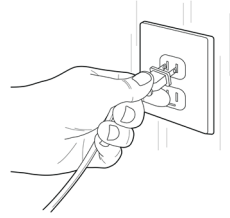

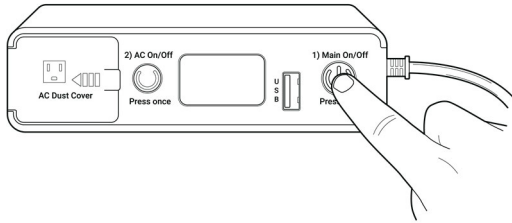

Turn ON the Battery Display

4) Press the **Main On/Off** button for 3 seconds to turn the battery ON.

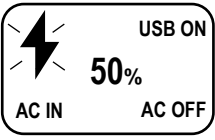

Once the button is pressed for 3 seconds, the screen will display:

	 = Charging	USB ON = USB has power
	50% = Battery life (Example shown at 50%)	
	AC IN = AC Charging Cord is powering the battery	
	AC OFF = AC Outlet (that can power a CPAP) is OFF	

Battery life increases when the charging cord is plugged into a power source. In time, the battery life indicator can display up to 100%. While in battery mode, battery life may not increase or drain consistently (i.e.: it may drain only 30% in 4 hours, but then drain 70% in the next 4 hours). Battery run times vary by PAP device, pressure, heated humidity and other factors.

Turn ON the AC Outlet

5) Press the **AC On/Off** button to activate the AC Outlet.

Your device will NOT receive power unless you press this button.

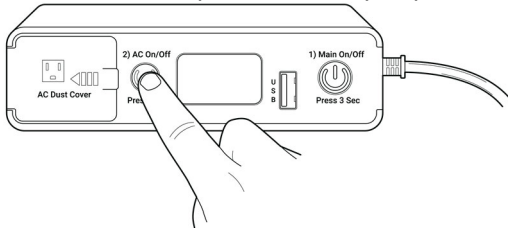

4

The AC On/Off Button

When you press the **AC On/Off** button, the display will change from "**AC OFF**" to "**AC ON**".

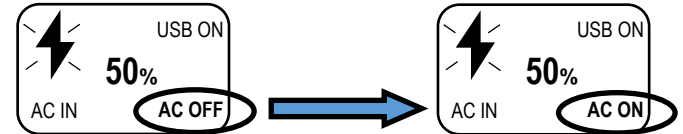

When using as an Uninterruptible Power Supply (UPS), set-up your CPAP or BiPAP device as shown below. While receiving therapy, the battery stays charged.

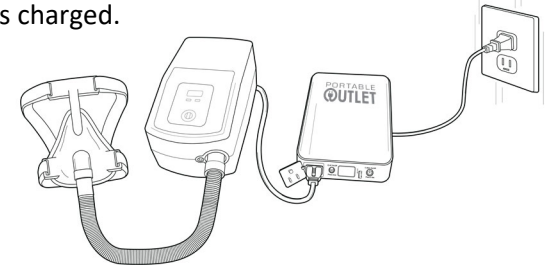

During a Power Outage

In the event of a power outage, the Portable Outlet instantly switches to the battery mode. You should not have any interruption to your CPAP or BiPAP therapy, until the battery is depleted.

The display will change when there is a power outage:

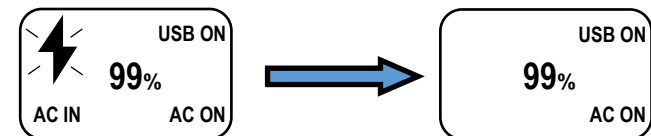

During a power outage, if the USB is not in use, the display will change from "**USB ON**" to "**USB OFF**". To activate the USB, simply switch off the **Main On/Off** button, and turn the system on again.

5

Using as a Stand-Alone Battery

Follow these instructions when using the Portable Outlet as a stand-alone battery, when travelling or during emergencies.

1) Charge your battery. Then plug your CPAP into the AC Outlet on the front of the battery.

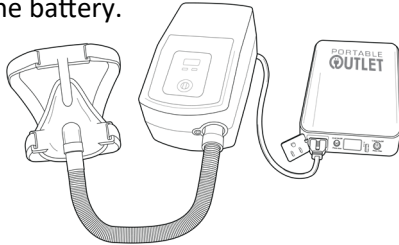

2) Press the **Main On/Off** button for 3 seconds to turn on the display. The display will look like this:

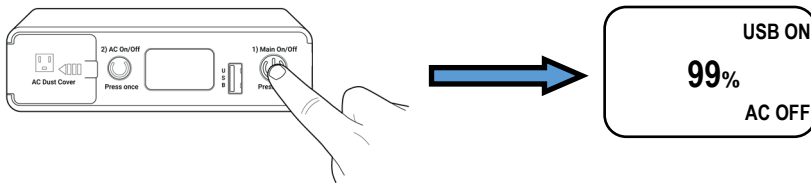

3) Press the **AC On/Off** button to turn on the AC Outlet. The display changes from “AC OFF” to “AC ON”.

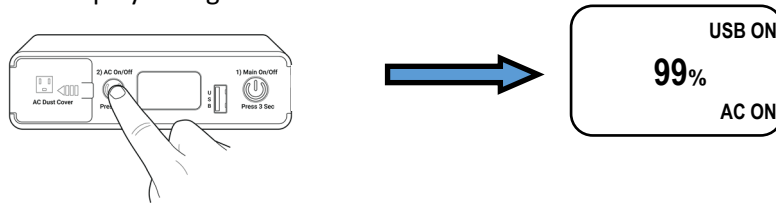

To conserve the battery, switch **OFF** the **AC On/Off** when it's not in use. To maximize battery life, when possible, turn OFF your Heated Tube, Heated Humidifier and avoid CPAP mask leaks. Visit www.PortableOutlet.com/maxlife to learn more.

Limited Warranty

- Please read the “Troubleshooting” section on the last page and/or visit www.po160ups.com and refer to the “Operating the PO160UPS” video BEFORE making a warranty claim.
- There is a 1 Year Limited Warranty on the battery beginning from the date of purchase. Proof of purchase is required which must include: your name, date of purchase and serial number of the battery in question. Warranty covers defects in the product due to faults in material or workmanship.
- The warranty will become VOID if repairs are attempted, or if the battery is opened.
- The warranty does not cover damage due to normal wear and tear and/or from improper use.
- Warranty or replacement is at the discretion of CPAP Life, LLC.

For more information visit www.portableoutlet.com/warranty.

Environmental Notice

This product contains a rechargeable lithium-ion battery. Please follow local regulations regarding battery disposals in your area.

Specifications - Model # PO160UPS

Battery Capacity:	159 Wh/14.4Ah
AC Input:	100-240V/50-60Hz
DC Input:	12-19V, 2-3.2A
AC Output:	110V/60Hz
USB DC Output:	5V, 3.0A
Rated/Peak Power Output:	100W/145W
Battery Recharging Time:	Approx. 4 to 5 Hours
Operating Temperature	40°F and 105°F
Weight:	2lbs, 14ozs.
Dimensions:	5-3/8" x 9" x 1.5"

Troubleshooting - Also visit www.po160ups.com

Problem	Possible Solutions
I do not get power from the battery.	First be sure it is turned ON by pressing the Main On/Off button for 3 seconds, then the AC On/Off button. The display must read " AC ON ".
I pressed the Main On/Off button for 3 seconds but nothing happened.	1) The battery is depleted. - Charge the battery 2) It had a power surge, or overloaded. - Wait 5 minutes and try again. Plug charging cord in battery, then wall outlet to reset it.
It has been plugged in over an hour and does not appear to be charging.	1) Confirm the charging cord is in the AC Input port on the right side of the battery. 2) Confirm the outlet you're using to charge the battery has power. Try another wall outlet.
How can I tell if the battery is charging?	Turn on the display by pressing the Main On/Off button for 3 seconds. When the charging cord is plugged in, the display will show a flashing ⚡ symbol and the words " AC IN ".
The display was on, but turned off when I plugged a device in the battery outlet.	The battery overloaded. Wait 5 minutes, or plug the charging cord in the battery, then wall outlet to reset it. NOTE: Overloads will continue if device you are powering has an output $\geq 100W$.
After an outage, it reads " AC ON ", but also " USB OFF ".	If the USB is not in use during an outage, it will soon display " USB OFF ". Press Main On/Off to turn OFF the battery, then turn it ON again.
Battery Life % drains & charges inconsistently.	See page 4. Battery Life % may not drain or charge consistently over the same hours. It may drain 30% in 4 hours, then 70% in 4 hours.
My CPAP only ran a few hours while using the battery.	When possible, follow these guidelines: 1) Turn OFF the Heated Tube when applicable. 2) Turn OFF or remove the Heated Humidifier. 3) CPAPs increase pressure to compensate for leaks. Replace your mask or try a Full Face Mask. Mouth leaks may occur with nasal masks. For more information and helpful tips visit www.PortableOutlet.com/maxlife .